

NHL Stenden guide

Leeuwarden – No. 1

This NHL Stenden guide (Leeuwarden site) is intended to help you with:

- handy maps;
- information on facilities within NHL Stenden;
- relevant contact details on information points.



**NHL
STENDEN**
university of
applied sciences

Accessibility

NHL Stenden University of Applied Sciences is easily accessible by private as well as public transport. There are car parks, bicycle cellars, a bicycle storage, and there is a bus stop in front of the entrance.



Opening hours NHL Stenden

Rengerslaan 8

Mon - Thur: 7.30am to 9pm
Fri: 7.30am to 7pm

Rengerslaan 10

Mon - Thur: 7.30am to 10pm
Fri: 7.30am to 6pm

For opening hours during holidays,
please see start.nhlstenden.com.

Public transport

During the day, take bus route 612 from Leeuwarden station (destination NHL Stenden) and get off at stop NHL Stenden. There are shuttle buses from and to Rengerslaan every 10 minutes. In the evening, the bus goes every 30 minutes; take bus route 8. For up-to-date bus times, see the screen in the Centrale Hal (Central Hall) at Rengerslaan 10 or go to 9292.nl.

Car

You can park your car in any of the three car parks of NHL Stenden. We want to be a good neighbour, which is why we ask you not to park your car in the neighbourhoods around NHL Stenden. The following car parks are available:

- South behind Rengerslaan 8;
- North opposite Rengerslaan 10;
- West (free parking) behind swimming pool De Blauwe Golf.

The car parks are open 24 hours a day. The rate is €2.50 a day. If you pay using your NHL Stenden MyCard, it will cost €1 a day. You can top up your card in the machine in the Centrale Hal (Central Hall) at Rengerslaan 8 and 10. If you have any questions, go to start.nhlstenden.com.

Bicycle

You can park your bicycle in the dedicated areas:

- bicycle storage facility behind Rengerslaan 8;
- bicycle cellar underneath Rengerslaan 10 (the entrances are to the South and West of the building at Rengerslaan 10, right next to the main entrance).

Do you have a flat tyre or broken rear lamp? For minor maintenance or repairs to your bicycle, you can go to the bicycle repair shop in the bicycle cellar underneath Rengerslaan 10.

Food & drink

There are various places where you can get something to eat or drink. We also have several terraces and gardens where you can enjoy your lunch or relax for a while. See the maps for their exact locations. For a delectable sandwich, soup, hot meal or delicious cup of coffee, you can go to any of the following facilities:

Rengerslaan 8

Café IF

For good coffee, tea, pastries, toasted sandwiches and salads.

Payment: Debit card

Mon: 10.15am to 3.30pm

Tue, Wed, Thur: 8.30am to 3.30pm

Fri: 8.30am to 3pm

Canteen

Take your pick from different world cuisines for a delicious lunch or hot meal.

Payment: Debit card

Mon - Thur: 8am to 7.30pm

Fri: 8am to 6pm

Central Brew

For a good start to your day with fragrant coffee, tea and a snack.

Payment: Debit card

Mon - Fri: 8am to 4pm

Rengerslaan 10

Café

To make new plans, review your day or just chat with friends while enjoying a drink and a bite to eat.

Payment: Debit card or MyCard

Mon - Fri: 10am to 6pm

Espresso bar

Good coffee, delicious pastries or even a nutritious breakfast.

Payment: Debit card

Mon - Fri: 8am to 7pm

Food Court

A bakery, salad bar, fresh smoothies and nice dinners. Everything is freshly prepared using local products.

Payment: Debit card or MyCard

Mon - Fri: 9am to 6pm

Student Info

Student Info (formerly iStudy/Student desk) can answer all your questions about the organisation of education, such as your enrolment/disenrolment, Studielink, Progress (scores and test registration), booking rooms and classrooms, help with filling in forms (OCW duo), study abroad (International Mobility Office), general information about study programmes and appointments with the student dean.

Students who, for whatever reason, encounter problems in the course of their study can contact the student dean to discuss their problems, request information and consider follow-up steps and solutions. Student deans are independent and conduct confidential conversations with students.

Do you have any other questions and are you unsure who to turn to? Then you can also contact Student Info.

E studentinfo@nhlstenden.com

T +31 (0)58 244 1155

Rengerslaan 8, Centrale Hal (Central Hall), 0.44

Mon - Fri: 8.30am to 4.30pm

Rengerslaan 10, Centrale Hal (Central Hall), B0.028

Mon - Thur: 8am to 6pm

Fri: 8am to 1pm

Studieadviescentrum (Study Advice Service)

Do you wonder whether you have chosen the right study programme? Do you need help to explore other study options? Then contact the Studieadviescentrum.

E studieadvies@nhlstenden.com

T +31 (0)58 251 3400

Rengerslaan 10, Centrale Hal (Central Hall), B0.028

Mon - Fri: 9am to 12.30pm and 1 to 5pm

Studying abroad

Would you love to have a study period abroad? Then join our Grand Tour of Exchange programme! For questions about studying abroad, please contact Team International Mobility.

E: Exchange@nhlstenden.com

Grandtour@nhlstenden.com

Rengerslaan 8, ground floor 0.43

T +31 (0)58 244 1466

Mon - Fri: 8.30am to 5pm

Rengerslaan 10, ground floor B0.028

T +31 (0)58 251 1883

Mon - Fri: 8.30am to 5pm



Bibliotheek (Library)

The library of NHL Stenden offers a welcoming and inspiring place for students and staff to study, do research or meet up. In addition to a comprehensive paper collection, the library also has a balanced digital collection that is accessible 24/7. Support is offered in various areas: from looking for information, writing reports or a thesis to quotation of sources and requesting an ISBN.

Opening hours of the library at Rengerslaan 8 (ground floor, near study landscape)

Mon - Fri: 8.30am to 5pm
T: +31 (0)58 244 1717
E: library@stenden.com

Opening hours of the library at Rengerslaan 10 (ground floor, Centrale Hal (Central Hall) in room D0.001)

Mon + Fri: 8.30am to 5pm
Tue, Wed, Thur: 8.30am to 7.30pm
T: +31 (0)58 251 1755
E: mediatheek@nhl.nl
WhatsApp: +31 (0)6 38 14 78 12

iShop/Document Centre

For office supplies, postcards and NHL Stenden merchandise, you can go to the iShop (Rengerslaan 8) or to the Document Centre (Rengerslaan 10). For printing and binding, you can contact the Document Centre. You can hand in your orders in person or use the digital order form for staff and students via dc.nhl.nl/studentopdracht.

iShop

Rengerslaan 8 (ground floor in room 0.26)

Mon - Fri: 8am to 4.30pm (closed for lunch)
Telephone: +31 (0)58 244 1331
E: ishop.leeuwarden@stenden.com

Document Centre

Rengerslaan 10 (ground floor, Centrale Hal (Central Hall) in room E0.006)

Mon - Fri: 8.30am to 5pm
T: +31 (0)58 251 1808
E: dc@nhl.nl

Self-service: selfservice.nhlstenden.com

Molen de Eendragt (Windmill De Eendragt)

Molen De Eendragt is a venue for discussion and contemplation. The mill's sails are permanently set in a position expressing joy. The venue offers philosophical, anthropological and ideological activities. The NHL Stenden Meditation room is also located in the building. It houses Muslim, Christian and Hindu prayer rooms and facilities. The mill also houses Vonkt (previously the Centrum voor Levensbeschouwing/Centre of Philosophy of Life) and Expect student pastoral care.

More information

Would you like to know more about Vonkt? Check the website vonkt.nl. Or contact them via +31 (0)58 244 1891 or email on mail@vonkt.nl.

Would you like to know more about Expect? Then check expect-leeuwarden.nl/blog. Or contact them via +31 (0)6 16 90 07 or email on mail@expect-leeuwarden.nl.

Kapsalon Teach-Inn (Hairdressers)

Do you need a haircut and would you like to help Friese Poort students become professional hairdressers? Then have your hair cut by them at competitive prices. The Teach-Inn salon is at Rengerslaan 8 (room 0.79). You can also get in touch by telephone on +31 (0)58 244 1661.





Practical information

NHL Stenden MyCard

You can use your personal MyCard for facilities offered by NHL Stenden. You will use your MyCard mainly for:

- identification for tests, in combination with a valid proof of identity;
- printing;
- parking at the NHL Stenden rate (€1 a day). Within NHL Stenden, the MyCard also serves as proof of enrolment.

Topping up MyCard

You can top up your card in the machine in the Centrale Hal (Central Hall) at Rengerslaan 8 and 10.

Internet

For more information about WiFi access, go to Self-service via selfservice.nhlstenden.com.

Copying and printing

There are various 'multifunctionals' scattered throughout the buildings where you can copy, print and scan documents. You can pay using your MyCard. After you have given a print order, you can just walk to any multifunctional to pick up your prints. You can do so by holding your MyCard in front of

the reader. The screen of the multifunctional will display your personal print orders. In case of a printer error, contact the Serviceplein (Service Square): +31 (0)58 251 2552.

Pakket Service (Parcel Service)

Have you placed an online order, but you do not fancy waiting at home for the delivery of your parcel? Try the MYPUP service. MYPUP is a Pick-Up Point for parcels in the form of a locker cabinet. The lockers are located at Rengerslaan 10, Central Hall, next to the Document Centre. You can use the lockers for delivery from and return to any online shop in the world. Sign up for free at mypup.nl, and follow the instructions.

Lockers

There are lockers where you can store your personal belongings in various locations in the building. They are intended for temporary use during the day. At Rengerslaan 8, security empties all lockers at midnight. Any property left behind can be picked up at reception. The lockers are automatically blocked at midnight at Rengerslaan 10. You can have a locker deblocked at the Serviceplein (Service Square).

Workplace

Are you looking for a quiet place to work or study? Would you like to bring your team up to date in a break-out room? Then simply check the availability of the break-out rooms and the activity in the study landscapes via the NHL Stenden room management system. Download the Officebooking blue app. Open the app and select login with Surfconext. Then select NHL Stenden and your location in the menu. For more information, go to: officebooking.net/en/check-your-spot.



Internal rules

Smoking and smoke-free zones

A smoking zone will be realised at the Kennisplein (Knowledge Square; between Rengerslaan 8 and 10) shortly. The areas near the entrances to the buildings are smoke-free zones.

Internal rules and code of conduct

You can find all our internal rules and code of conduct on start.nhlstenden.com.



What to do in an emergency?

NHL Stenden has a protocol in place for emergencies such as a fire and other dangerous situations. If you discover a dangerous situation in or around the building, immediately report this to reception.

Rengerslaan 8, alarm number +31 (0)58 244 1234

Rengerslaan 10, alarm number +31 (0)58 251 2222

In the event of a fire alarm, you will hear a slow whoop and the building will be evacuated. Go to the meeting point and stay away from doors so that everyone can leave the building. The meeting point for Rengerslaan 8 is the parking area behind the building. The meeting point for Rengerslaan 10 is the Kennisplein (Knowledge Square; square between Rengerslaan 8 and 10).

Always leave via the nearest emergency exit. These are indicated by means of green lit signs. Follow the instructions from the lecturers and ERS officers; the latter wear yellow vests marked "BHV". Do not use lifts.

PLEASE NOTE: instructions from ERS officers always take precedence!

In case of an emergency: call +31 (0)58 244 1234 (Rengerslaan 8) or +31 (0)58 251 2222 (Rengerslaan 10). Always state your name, the victim's condition, the location/room.

In case of urgent matters: immediately call 112 and alarm number

EHBO-ruimtes (First aid rooms):

Rengerslaan 8:
Ground floor: 0.40

Rengerslaan 10:
Ground floor: B0.012
2nd floor: D2.073
3rd floor: G3.001

Building layout

The rooms at Rengerslaan 8 are numbered as follows:

- The main building does not have a letter.
- A is the part of the building at reception.
- The 1st number in the series refers to the floor.
- The last 2 numbers indicate the number of the room.

For example: A2.11 is classroom 11 (nieuwe Collegezaal) in building part A on the 2nd floor.

Rengerslaan 8

	Floor	Zone
Academy of Commerce & International Business	2	
Academy of Communication & Creative Business	3	
Academy of International Business Administration	BG	
Academy of Leisure & Tourism	2	
Auditorium	BG	A
Café IF	BG	
Canteen	BG	
Central Brew	BG	A
Executive Board (EB)	1	A
Executive Staff	1	
Expertnet	1	B
Facility Management Department	0	C
Finance & Control Department	1	C
First aid room	BG	
HRM Department	1	C
International Mobility Office ³	BG	
iShop	BG	
Liaison Unit International Affairs	1	A
Liaison Unit R&D Education and Research	1	B
Library	BG	
Procurement ²	1	C
Reception	BG	A
Reception Stenden Hotel	BG	
Restaurant Wannee	BG	
Scheduling and Planning ¹	BG	C
Stenden Hotel	BG	
Stenden Hotel Management School	1	
Student Counsellors (Student well-being) ¹	BG	
Student Info ⁴	BG	
Teach-Inn Hairdressers	BG	

¹ Part of the service Onderwijslogistiek & Studentondersteuning (Educational Logistics & Student Support).

² Part of the Finance & Control Department.

³ This used to be the Student Mobility Center. It is now part of the Verbindingseenheid International Affairs (Liaison Unit International Affairs).

⁴ Formerly iStudy/Studentloket.



The rooms at Rengerslaan 10 are numbered as follows:

- A capital letter for the zone (A up to H) of the floor in question.
- The number of the floor (0 up to 3).
- The number of the room.

For example: F3.025 is classroom 25 in zone F on the 3rd floor.

Rengerslaan 10

	Floor	Zone
Academy of Economics & Logistics	3	F
Academy of Healthcare	2	C
Academy of ICT & Creative Technologies	3	D/F
Academy of Primary Teacher Education	0	C
Academy of Social Studies	2	C
Academy of Teacher Education	0/1/2	A/B/C/D
Academy of Technology & Innovation	2	G/H
Auditorium	1	A
Café	BG	A
Central Hall	BG	D
Digital Learning & Working Environment	BG/3	B/E
Document Centre	BG	E
Espresso bar	BG	Hal
Eventmanagement	BG	A
First aid/Breast feeding area	2	D
First aid/Breast feeding/Rest area	3	G
First aid room	BG	B
Flexible Learning	BG	Hal
Food Court	BG	A
House of the Present ⁵	2	B
International Mobility Office ⁶	BG	Hal
Learning Centre	2	F
Library	BG	D
Maritime Institute Willem Barentsz; MIWB	3	G
Marketing & Communication Department	3	E
Open University	BG	B
Parcel Service	BG	Hal
Participation Council Support Office	3	G
Quality of Education & Research Department	3	E
Reception	BG	D
R&D Focus areas and Contract Activities	3	G
RUG	BG	A
Service Square	BG	B
Student Administration ⁷	BG	A
Student Counsellors (Student well-being) ⁷	1	A
Student Info ⁸	BG	Hal
Study Advice Service ⁷	BG	Hal
Test Logistics ⁷	1	B
Theatre	1	
Thorbecke Academy	3	D
X-Lab	BG	D

⁵ Is part of the Gezondheids Expertise & Educatie Centrum Friesland (Health Expertise & Education Centre Friesland) and the lectoraat iHuman (iHuman professorship).

⁶ This used to be the Student Mobility Center. It is now part of the Verbindingseenheid International Affairs (Liaison Unit International Affairs).

⁷ Part of the dienst Onderwijslogistiek & Studentondersteuning (Educational Logistics & Student Support).

⁸ Formerly iStudy/Studentloket.

Floor plan Rengerslaan 8

Ground floor

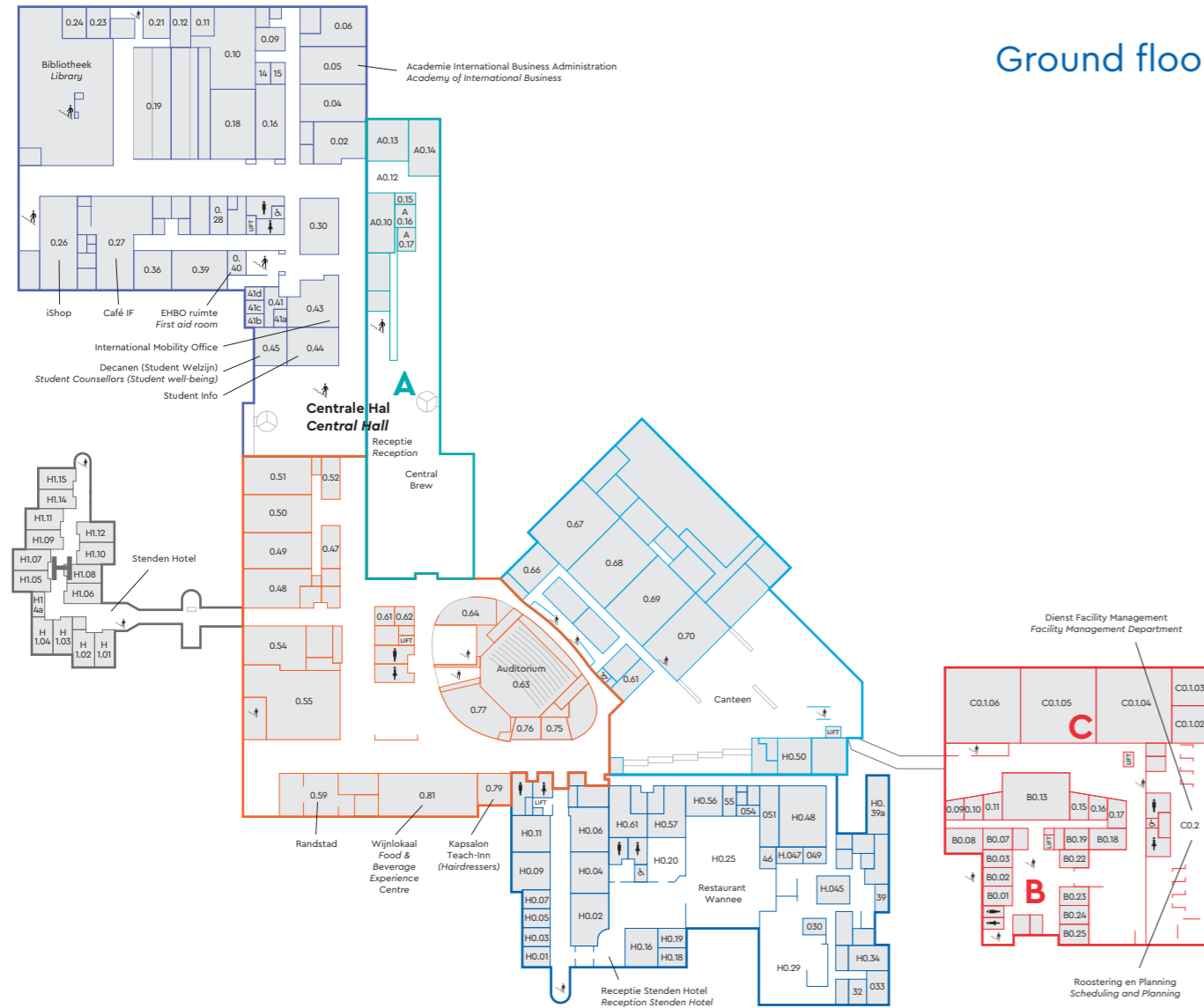

First floor

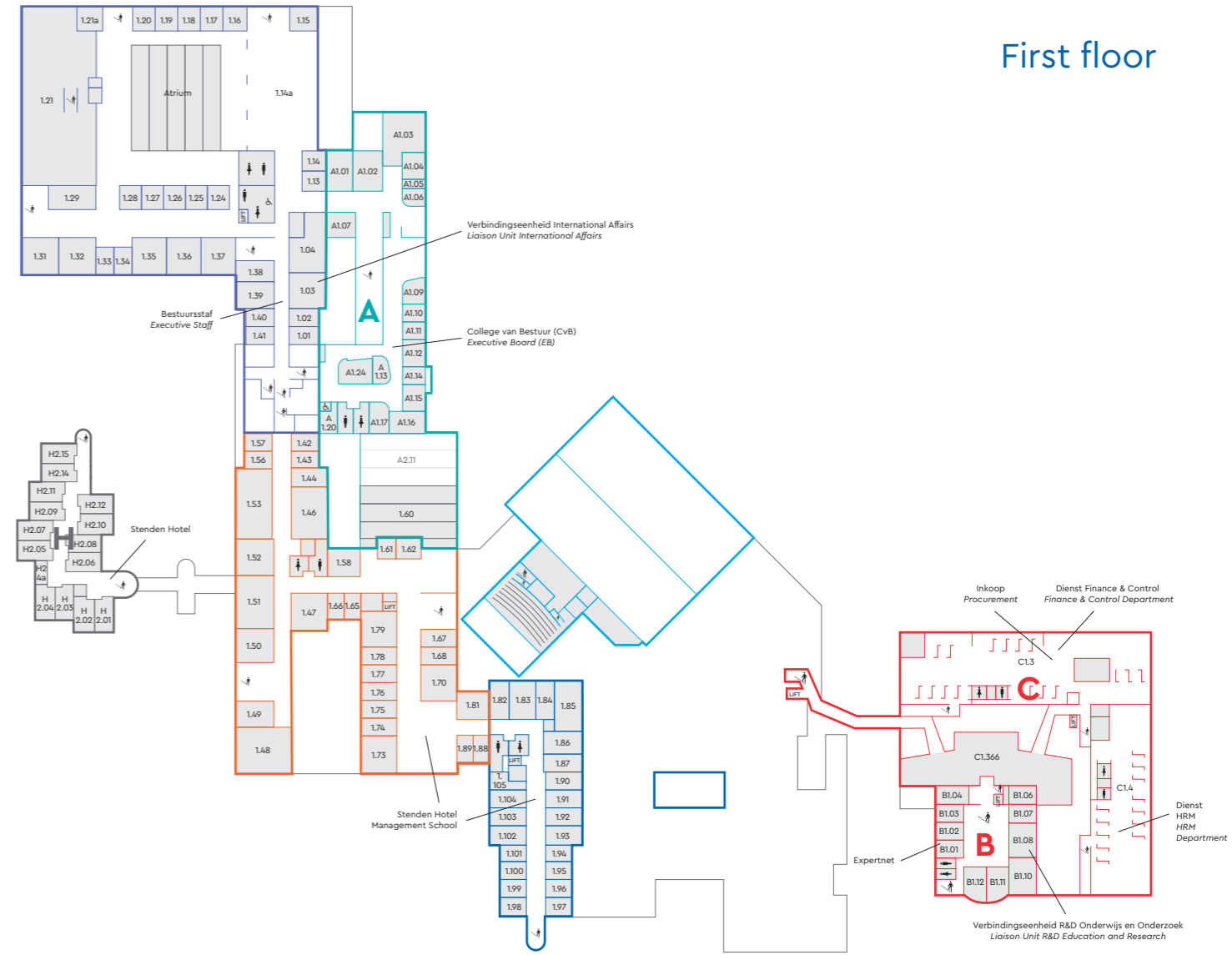

Floor plan Rengerslaan 8

Second floor

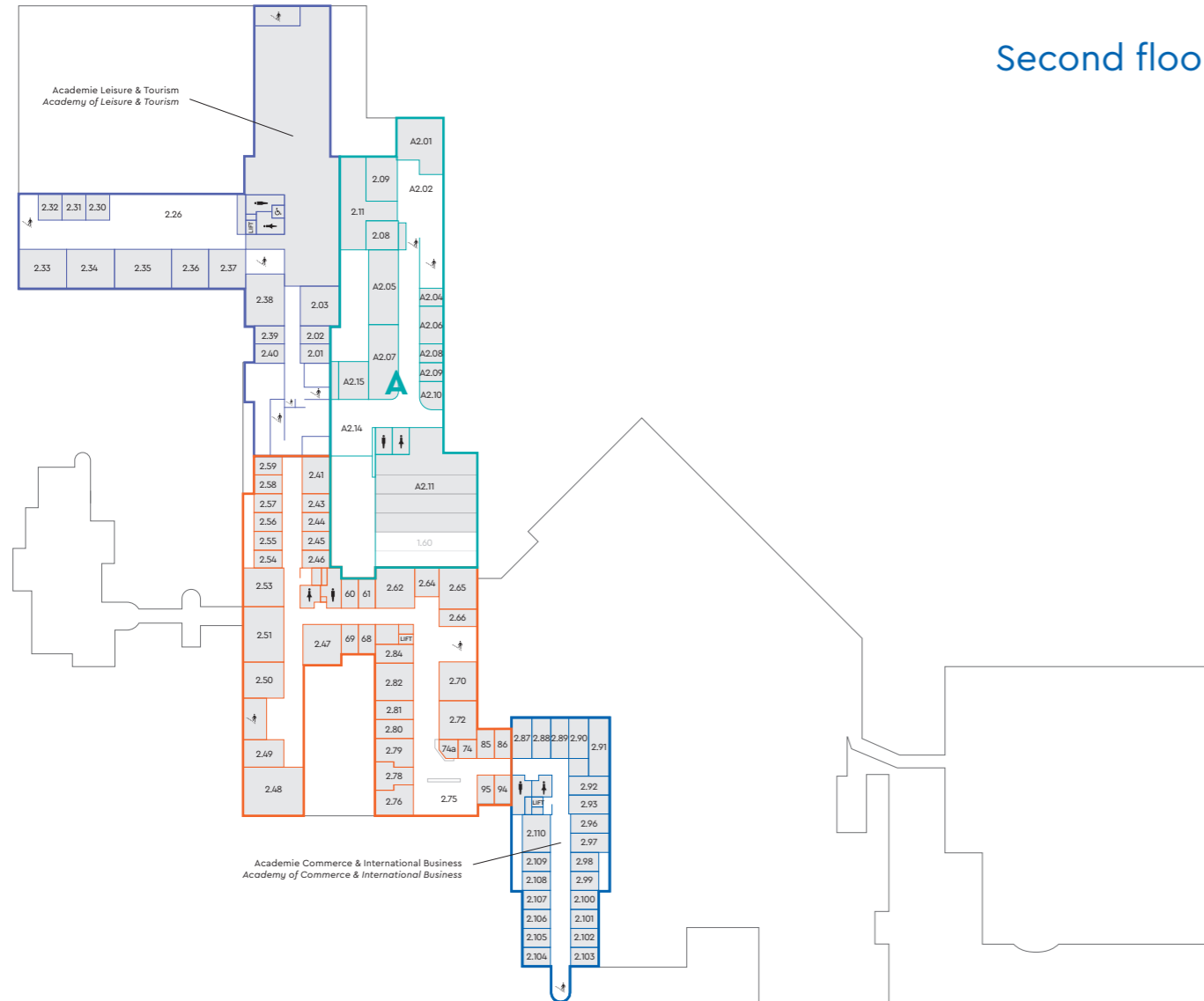

Third floor

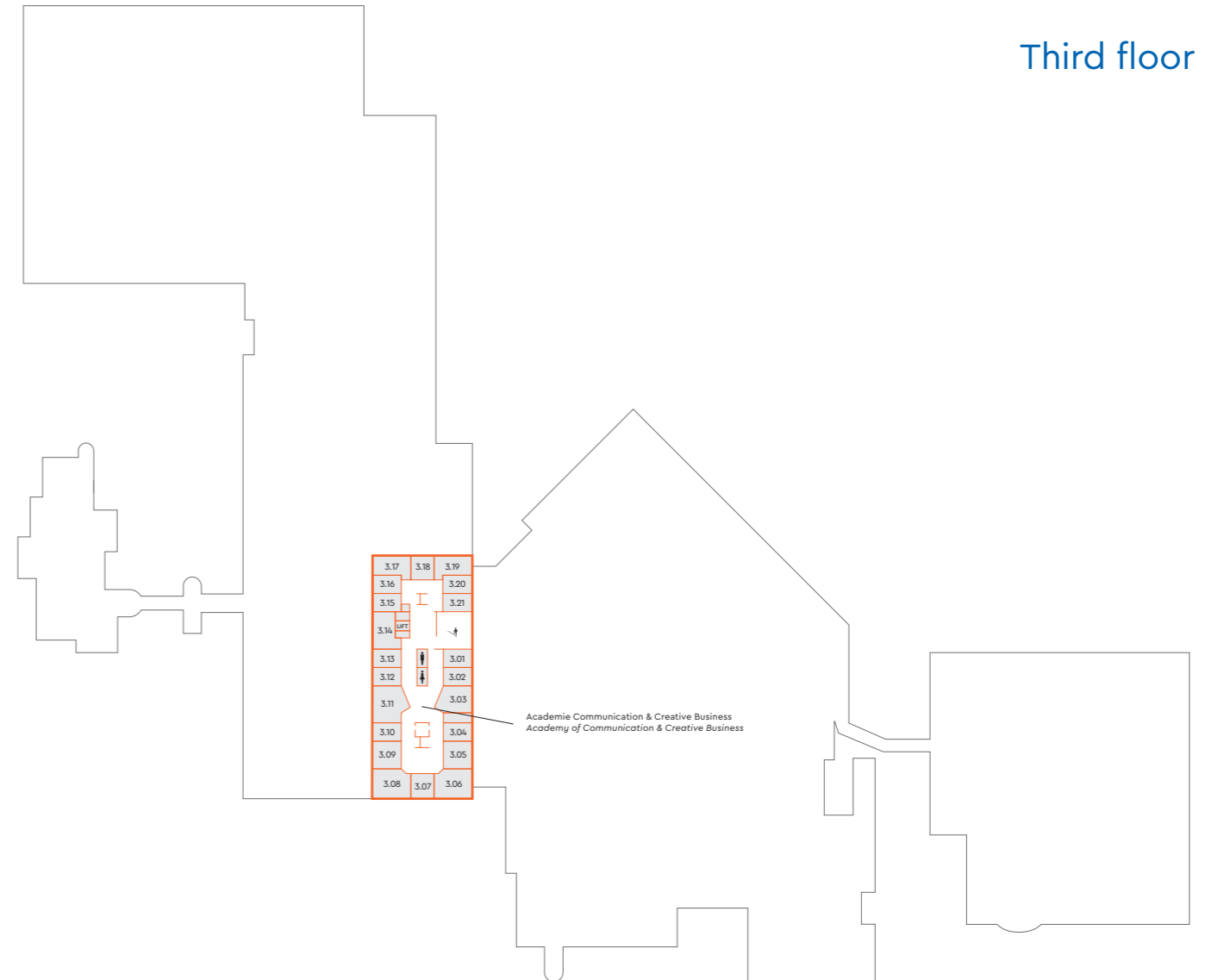

Floor plan Rengerslaan 10

Ground floor

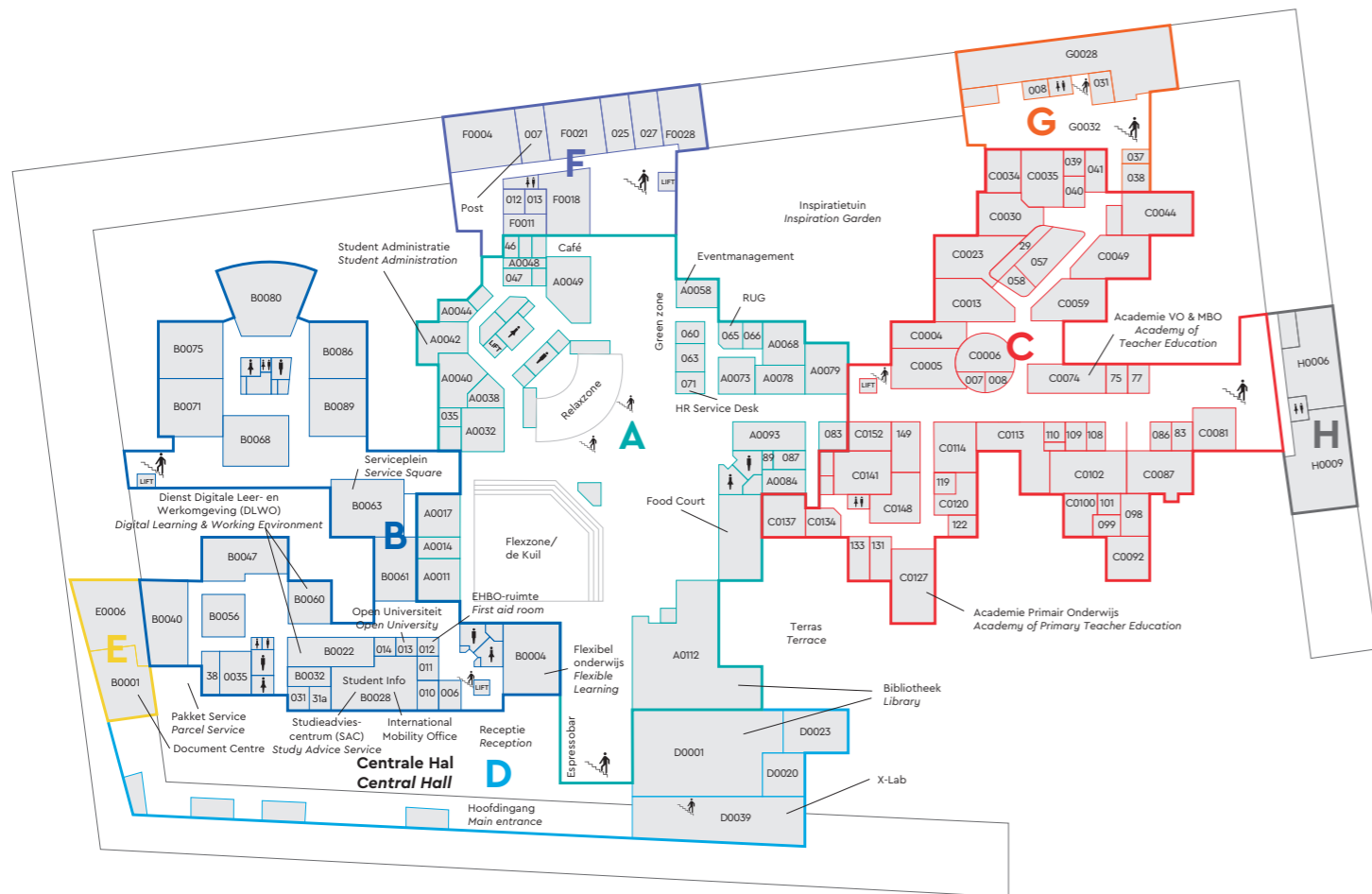

First floor

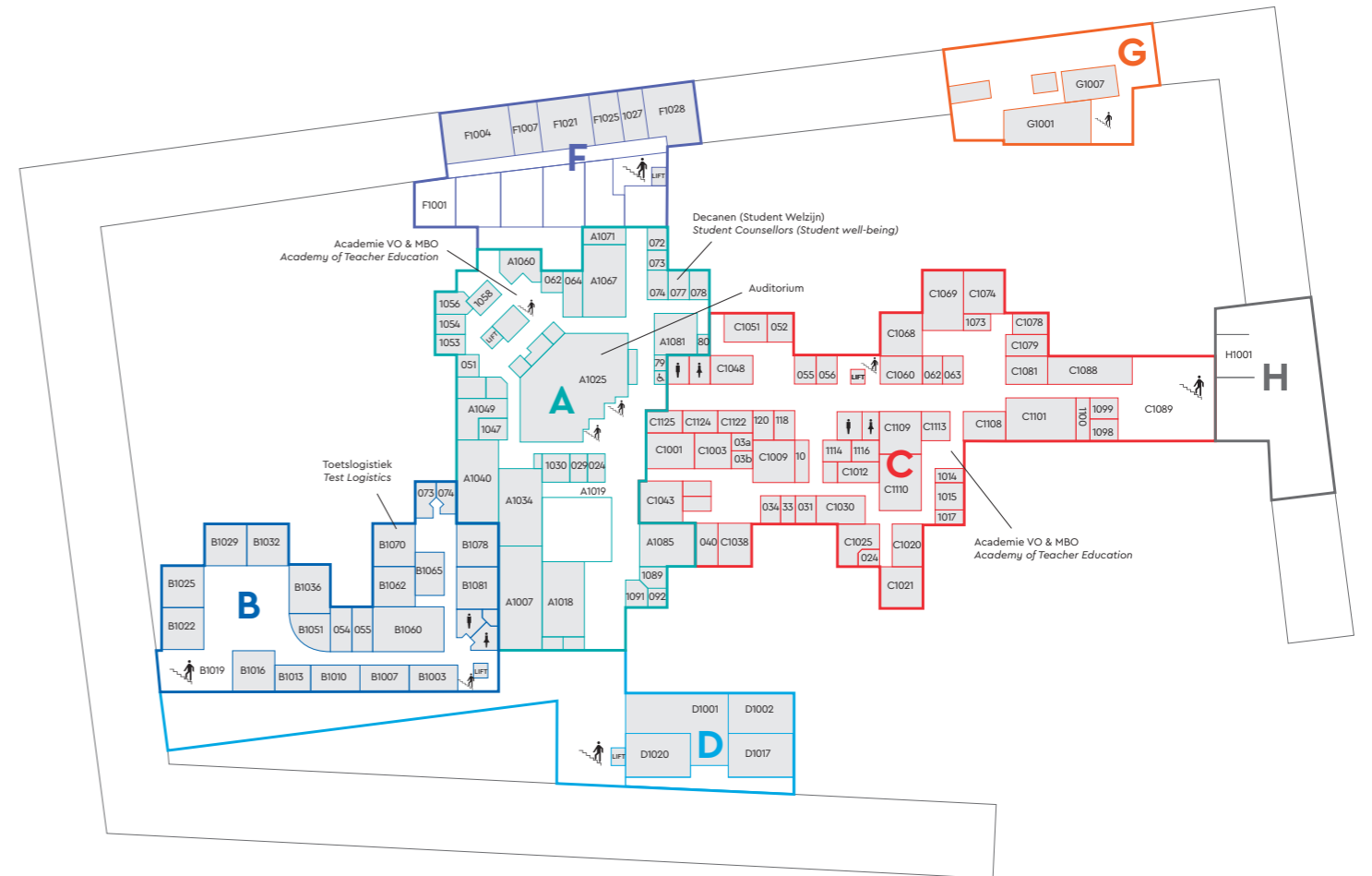

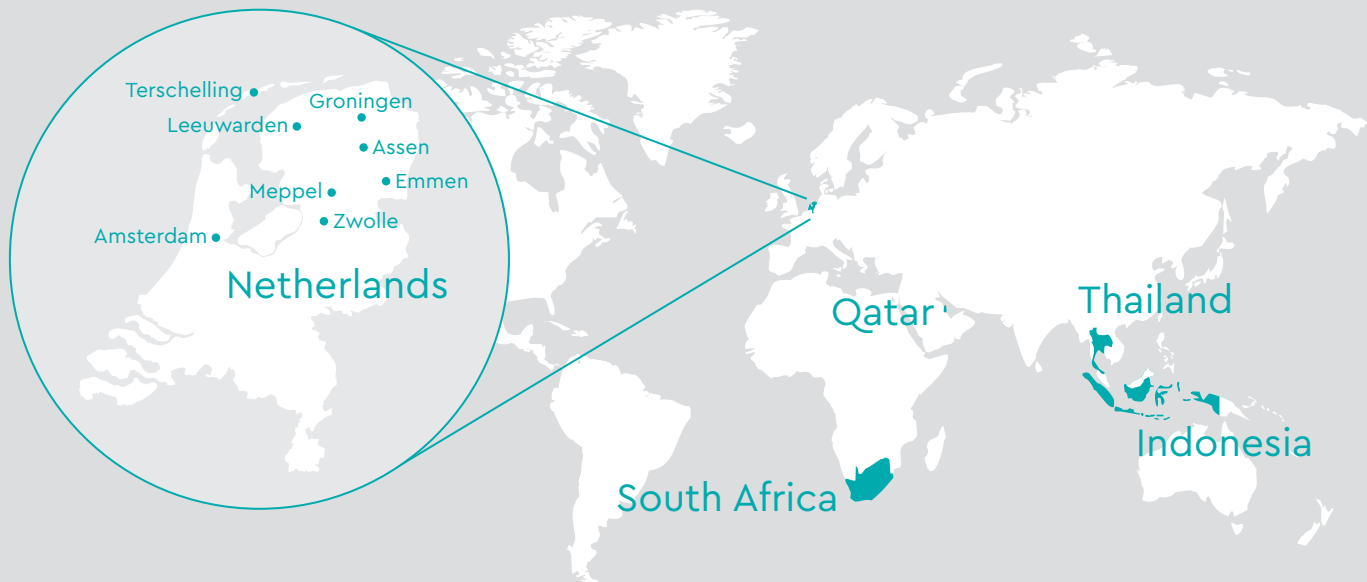

If you want to find out where
NHL Stenden locations are, check
nhlstenden.com/en/locations

The information in this guide has been carefully compiled. Nevertheless, upon publication of this booklet, it may be outdated. NHL Stenden University of Applied Sciences is not responsible or liable for any damage or loss that may be caused directly or indirectly by the contents of this guide. You can find the latest version of this guide on start.nhlstenden.com.



**NHL
STENDEN**

university of
applied sciences

Visiting address

Rengerslaan 8 – 10
8917 DD Leeuwarden

Postal address

PO Box 1080
8900 CB Leeuwarden

E: studentinfo@nhlstenden.com

T: +31 88 991 7000

 [nhlstenden](#)

 [nhlstenden](#)

 [nhlstenden](#)

 [nhlstenden](#)